

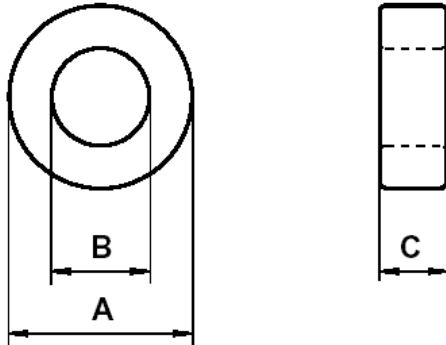

Specification for:  
**YF-40502-TC**

111 Zeta Drive  
Pittsburgh, PA 15238  
Phone: 412/696-1333  
Fax: 412/696-0333  
Email:magnetics@spang.com

**DIMENSIONS**



(mm)	Uncoated Nominal:	Coated Min:	Coated Max:
O.D. (A)	3.94	3.66	4.22
I.D. (B)	2.24	1.95	2.53
Ht. (C)	1.27	1.01	1.53

Eff. Parameters		
A <sub>e</sub> mm <sup>2</sup>	l <sub>e</sub> mm	V <sub>e</sub> mm <sup>3</sup>
1.05	9.2	9.7

**INDUCTANCE**

AL value (nH/T <sup>2</sup> )	Test conditions
440 ± 20%	10 kHz, 0.5 mT (For N = 5, use 0.14 mA), 25°C

**CORE LOSSES**

P <sub>L</sub> max	Production lot limit Max avg	Test conditions
2.1 mW (220 mW/cm <sup>3</sup> )	1.9 mW (200 mW/cm <sup>3</sup> )	25 kHz, 200 mT, 100°C
-	-	-

**COATING**

Parylene rated for 130°C continuous operation.
Voltage breakdown rating 1000 V Min Wire-to-Wire.

**NOTE**

Spec. Modifications	Previous	Revised
2005.06.08	Losses: General F material	Losses: Detail as indicated